

A New Residence By

PAUL TIFFANY

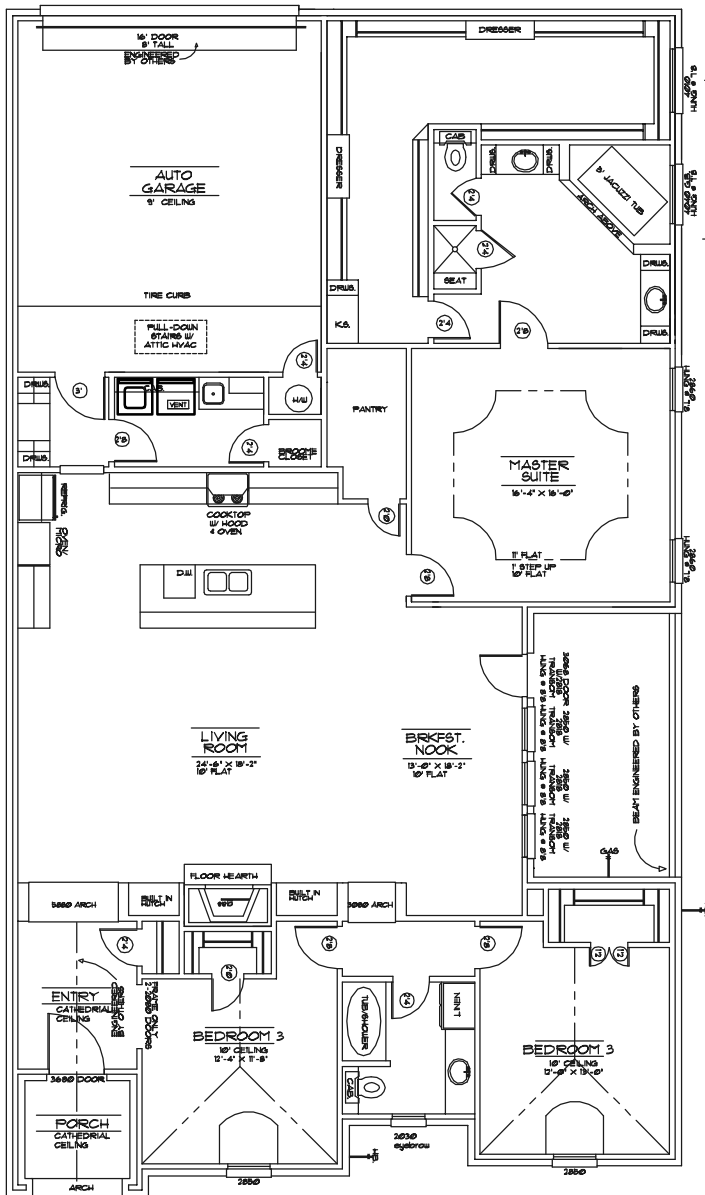

NOTE: ALL BEAMS OVER 9' SHALL BE ENGINEERED
ALL AREAS ARE APPROXIMATE

AREAS:	
FIRST FLOOR LIVING	2441 S.F.
AUTO STORAGE	475 S.F.
SIDE PATIO	155 S.F.
FRONT PORCH	65 S.F.
TOTAL UNDER ROOF	3136 S.F.

PLAN #12176